

PHDX TIGHTENER

PARTS LIST FOR ALL MODELS

PHDX-34
ITEM NO. 2617907

PHDX-114
ITEM NO. 2615907

PHDX-114RB
ITEM NO. 2615908

PHDX-2
ITEM NO. 2615916

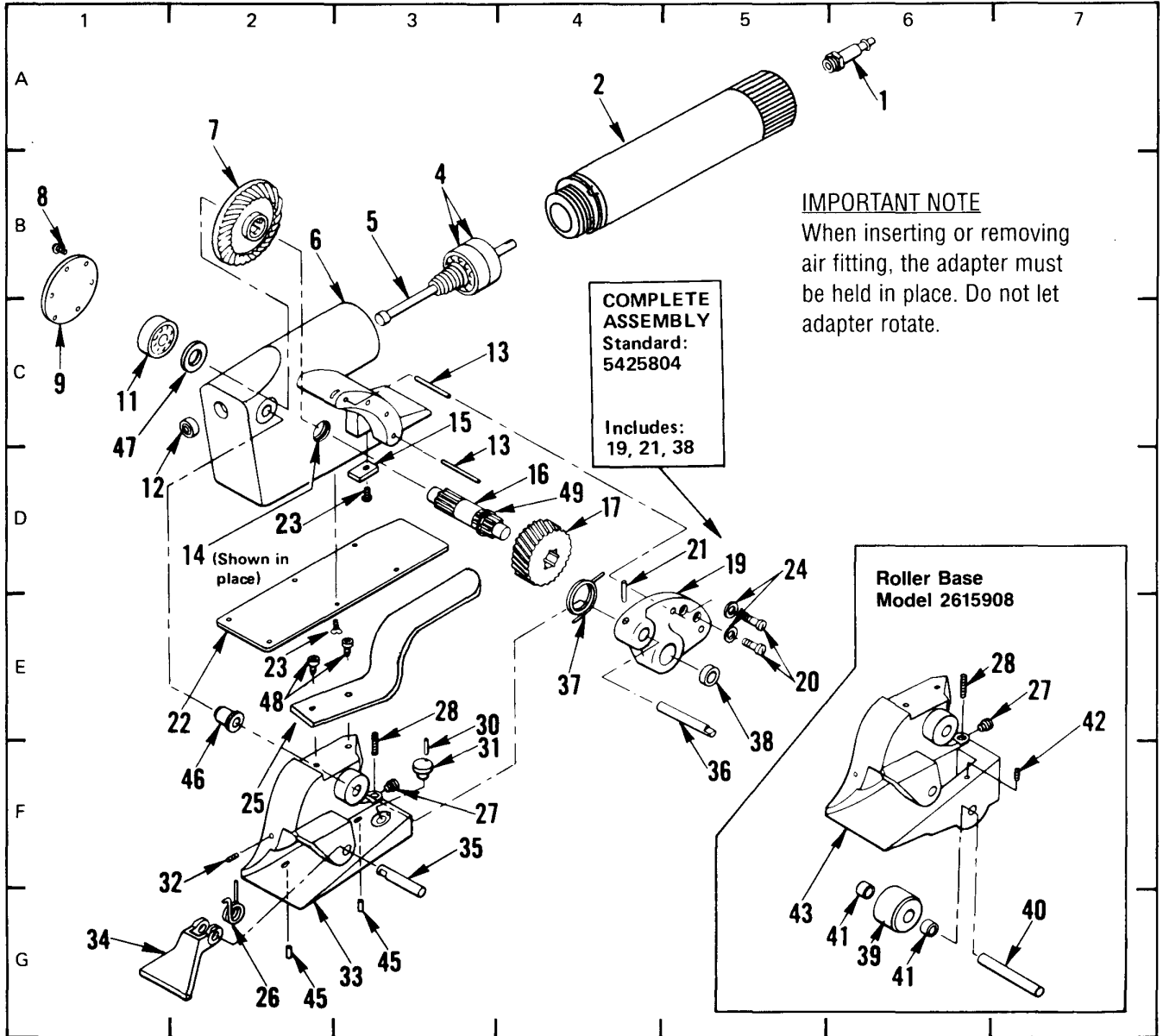

IMPORTANT NOTE:

Thrust washer (index #47) must be used with new spiroid gear (index #7) to avoid damage to gear train.



STRAPPING PRODUCTS
ACME PACKAGING CORPORATION
A SUBSIDIARY OF ACME METALS INCORPORATED

1303 CORBIN AVENUE
NEW BRITAIN, CT 06053-3805
(011) 708-849-2500

<u>Index No.</u>	<u>Part No.</u>	<u>Part Name</u>	<u>No. Req'd.</u>	<u>Index No.</u>	<u>Part No.</u>	<u>Part Name</u>	<u>No. Req'd.</u>
1	5435151	Air Fitting	1	25	5425205	Release Handle	1
2	5425209	Power Unit 8050A	1	26	5425060	Flapper Spring	1
4	5425043	Ball Bearing 202KDDC4FS	2	27	5425140	Brass Gib Set Scr.	1
5	5425006	Spiroid Pinion	1	28	5900093	1/4-20 x 3/4	1
6	5425821	Gear Housing Ass'y (Includes#12.)	1	30	5425021	Anvil Roll Pin	1
				31	5425181	Anvil	1
7	5425005	Spiroid Gear	1	32	5425026	#10-24 x 1/4 Soc. Set Scr.	1
8	5462039	#10-24 X 1/2 Fl. Hd. Soc.	13	33	5425830	Duck Bill Ass,y (Inc. mdx. 25. 48)	1
9	5425009	Gear Housing Cap	1	34	5425003	Flapper (2" 5403002)	1
11	5430013	Ball Bearing	1	35	5425013	Flapper Pin	1
12	5425020	Needle Bearing	1	36	5425039	Duck Bill Pivot Pin	1
13	5425022	Dowel Pin	2	37	5425015	Duck Bill Spring	1
14	5425030	O-Ring	1	38	5435135	Du Dry Bearing	1
15	5425183	Stop Plate	1	39t	5425052	Roller Anvil	1
16	5425822	Tightening Wheel Shaft	1	40t	5425053	Roller Anvil Pin	1
17	5425008	Tightening Wheel	1	41 t	5425054	Roller Anvil Bushing	2
19	5425004	Support Plate	1	42t	5425040	Set Screw	1
20	5462060	#10-24 x 5/8 Soc. Hd. Cap Scr.	2	43t	5425831	Duck Bill Ass,y (Inc. Indx. 25. 48)	1
21	5132019	Roll Pin	1	45ff	5427051	Driv-Lok Pin	2
22	5425182	Base Plate	1	46	5425065	Socket	1
23	5462039	Soc. Screw	7	47	5740036	Thrust Washer	1
24	5120022	Lock Washer	2	48	5425206	1/4-20 x 5/8	2
				49	5425184	Retainer Ring	1

NOTE: To order complete gear housing assembly order Part No. 5425809
(Includes #6, 7, 8, 9, 10, 11, 12, 13, 15, 16, 22, 23, 44, 46, 47, 49)

To order complete Duck Bill Assembly order:
5425827 for PHDX-114 (Includes 26, 27, 28, 30, 31, 32, 33, 34, 35)
5425828 for PHDX-114RB (27, 28, 39, 40, 41, 42, 43)
5425826 for PHDX-2" (Same as PHDX-114 Order 2"Parts)
5425827 for PHDX-¾" (Same as PHDX-114 Add Index No. 45)

t Parts for PHDX-114RB
tt Parts for PHDX-¾